

CATALOGO TECNICO

Technical Catalogue



RACCORDI PORTAGOMMA E MICRORACCORDERIA BARBED AND MICRO FITTINGS



PLASTICA ALFA s.r.l



Azienda Certificata secondo le Norme
UNI EN ISO 9001 Certificato n° 303
UNI EN ISO 14001 Certificato n° 022

RACCORDI PORTAGOMMA - BARBED FITTINGS

Istruzioni per il montaggio - Assembly Instructions:

1. Tagliare il tubo
2. Inserire il raccordo nel tubo fino ad arrivare alla battuta

1. Cut the pipe
2. Insert the fitting into the pipe and push it to the beat



Materiali - Materials:

Art.: 12010 - 12011 - 14130 - 15120		ABS
Art.: 13010	Ø 16 - 20 Ø 16 - 90	ABS Polipropilene/polypropylene
Art.: 12014 - 12013 - 12015 - 12016 - 12040 - 12041 - 13020 - 14010 - 14020 - 14030 - 15010 - 16055 - 16053		Polipropilene/polypropylene
Art.: 12020		A - Polipropilene/polypropylene B - Poliammide - polyamide
Art.: 12030		A - ABS B - Poliammide - polyamide
Gommino termoplastica/thermoplastic rubber		Gomma termoplastica thermoplastic rubber

Derivazione con gommino (per tubo PVC)

Art. 12016

Offtake with rubber for PVC pipes

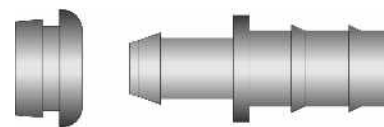
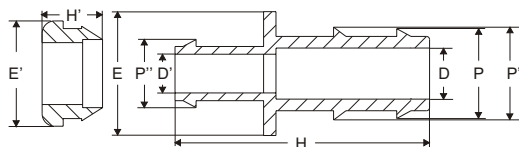

\varnothing	H	H'	P	P'	P''	D	D'	E	E'
16	49.5	14	15	16	14.5	10	9.5	22	24.5
20	47	14	19	20	15	14	10	21	24.5

Manicotto

Art. 13010

Coupling

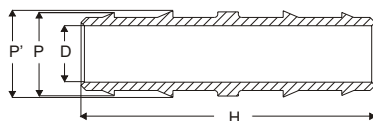

\varnothing	H	P	P'	D
16	52	15	16	10
20	53	19	20	13.5
25	89	24	25	17

Manicotto ridotto

Art. 13020

Reducing coupling

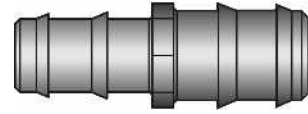
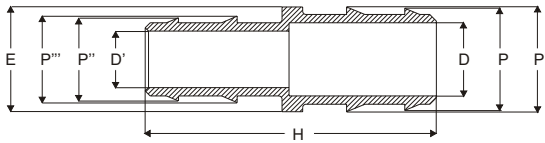

\emptyset	H	P	P'	P''	P'''	D	D'	E
20 X 16	52	19	20	15	16	14	10	21
25 X 20	88	24	25	19	20	17	12	23.5

T a 90° a portagomma

Art. 14010

90° barbed tee

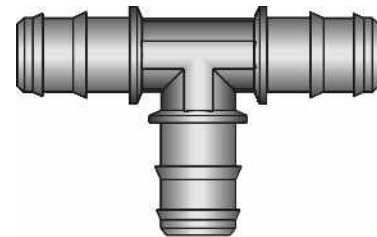
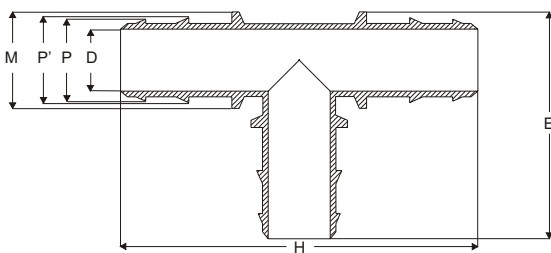

\emptyset	H	P	P'	D	M	E
16	64	14	16	10	13	39
20	98	19	20	14	23	60
25	104	24	25	19	28	66

Portagomma filettato maschio

Art. 15010

Male threaded barbed fitting

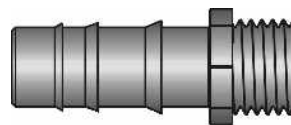
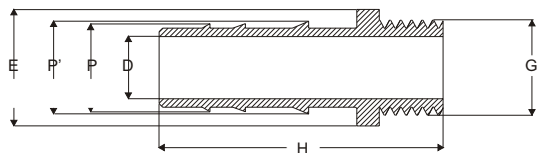

Ø	H	P	P'	D	E	G
16 x 1/2"	51	15	16	10	25	1/2"
16 x 3/4"	52	15	16	10	31	3/4"
20 x 1/2"	51	19	20	13	25	1/2"
20 x 3/4"	53	19	20	13	31	3/4"
25 x 3/4"	83	24	25	17	30	3/4"

Gomito a 90°

Art. 16055

90° elbow

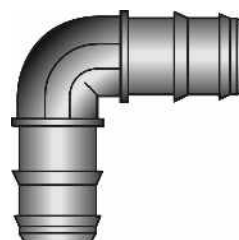
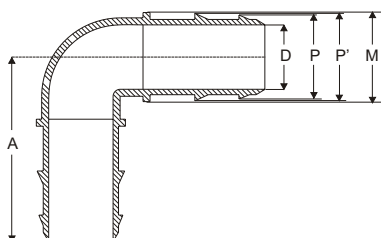

Ø	P	P'	D	M	A
16	15	16	10	22	39
20	19	20	14	23	49
25	24	25	18	27	52
32	31	32	24	31.5	60
36	35	36	28	35	62
40	39	40	31	38	67
50	49	50	39.5	49	72
63	62	63	49	57	127
75	74	75	60	67	138
90	89	90	69	79	145

Micro raccorderia ed accessori - Micro fittings and accessories

Istruzioni per il montaggio - Assembly Instructions:

1. Inserire il tubo ed il microraccordo nella pinza (pinza per l'inserimento delle olivette)
2. Eseguire un foro nella tubazione principale con l'apposita fustella
3. Connettere l'innesto alla tubazione principale

1. Insert the pipe and the fitting into the pliers (pliers to insert olivetta)
2. Punch the main line using the proper hollow punch
3. Connect the joint to the main line



Materiali - Materials:

Art.: 13030 - 13031 - 13032 - 13033 -
13034 - 13035 - 16032

Resina acetica/Acetal resin

Art.: 16030 - 13050

Polipropilene/Polypropylene

Olivetta di derivazione per tubicino in PE o PVC plastificato

Art. 13030

Olivetta with offtake for PE or plasticized PVC pipe

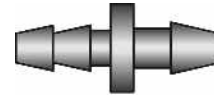
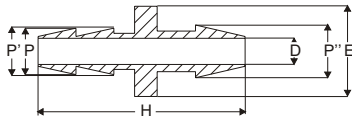

\varnothing	H	P	P'	P''	D	E
3.5 X 5	22	3	3.5	5	3	10
5 X 8	25	4.5	5	8	4	10

Olivetta filettata

Art. 13031

Threaded olivetta

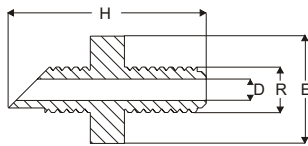

\varnothing	H	D	R	E
4	21	3	5	10

Anello di graffaggio Art. 13070

Clinching ring

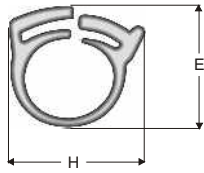

\emptyset	H	E
16	37	31

Doppio anello Art. 13060

Art. 13060

Double ring

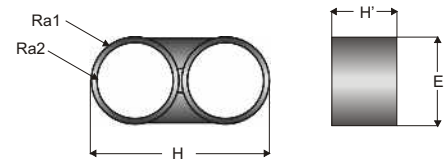

\emptyset	H	H'	Ra1	Ra2	E
16	42	13	11	8.5	23
20	52	14	13.5	11	27
25					

Tappetto ad innesto Art. 16030

Small plug

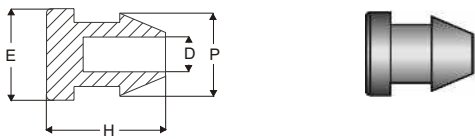

\emptyset	H	P	D	E
4				
6	12	6	3	10