

Scheda Tecnica *Technical sheet*

<h2>ART.3025</h2> <p><i>Female T coupler.</i> Size from $\varnothing 20 \times 1/2''$ to $\varnothing 90 \times 3''$.</p>	SPECIFICATION		APPLICATION	TECHNICAL NOTES
	Series	3025	Assembly in rigid pipe system	Made in compliance with the management requirements of the EN ISO 9001 standard
	Thread ends	Pipe-Piede-Female: PE-PE-UNI EN 10226	Nominal pressure (PN) in bar: 30	Conformity with DIN 8076 - EN 1254/3 - DVGW GW 335 UBA BWGL - UNI EN 681-1 and EN 682
	Orifice	from $\varnothing 20$ to $\varnothing 110$ mm	KV: Flowrate coefficient m^3/h Direction of flow: as desired	
	Technical additions		Temperature range: $-20^\circ C / +80^\circ C$	2 YEARS warranty
Flanged version: from $\varnothing 75$ to $\varnothing 11$ (* For $\varnothing 20$ nut material is: CW617N)		Use: Water	Manufactured in brass alloy compliant with EN 12165-CW617N-DW	

Standard version

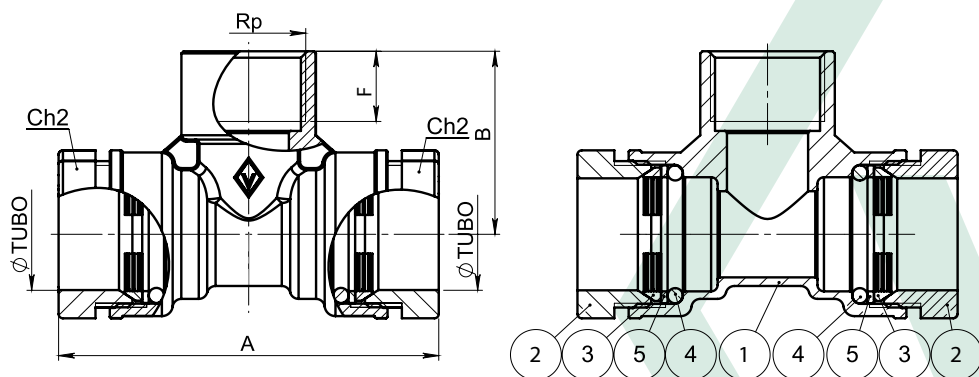

N°	Descrizione	Description	Materials	Q.ty
1	Corpo	Body	CW617N	1
2	Dado	Nut	CW602N (*)	2
3	Ghiera	Compression ring	CW614N	2
4	O-ring	O-ring	01/B70 NBR	2
5	Rondella	Brass ring	CW614N	2
6*	Vite	Screw	AISI 304	8
7*	Rondella	Brass ring	AISI 304	8

Flanged version: from $\varnothing 75$ to $\varnothing 90$

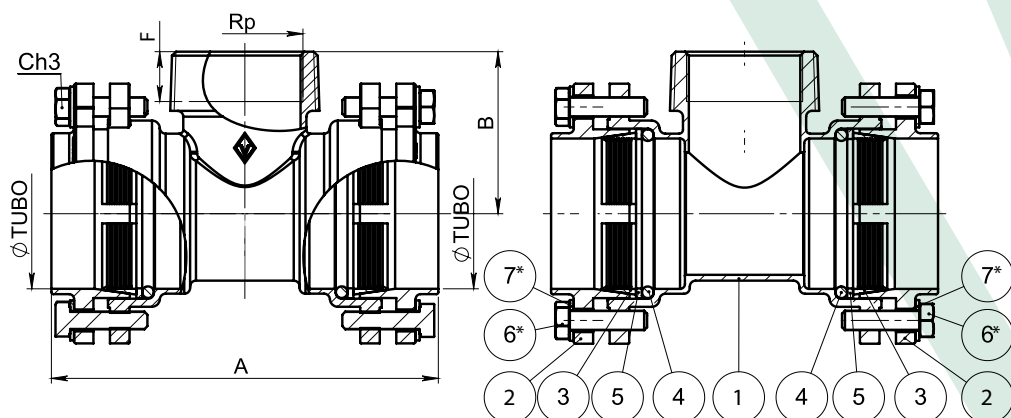

Rp	Ø PIPE	A	B	F	Ch2	Ch3	PN
1/2"	20	78	38,5	15	34		30
1/2"	25	88	39	15	39		30
3/4"	25	88	42,5	16,5	39		30
1"	32	105,5	50,5	19,1	48		30
1 1/4"	40	138	58,5	21,5	58		30
1 1/2"	50	149,5	64,5	21,5	69		30
2"	63	166,5	76,5	26	82		30
2 1/2"	75	226	75	26		17	30
3"	90	259	85	30,5		17	30

N° Disegno / Drawing Nr	Misure / Size		UFFICIO TECNICO
3025	$\varnothing 20 \times 1/2'' - \varnothing 90 \times 3''$		